

EXTERNAL - 2-TURN MEDIUM DUTY

HOW TO IDENTIFY

1. Verify multi-turn design and appearance.
2. Measure the shaft diameter (Ds).
3. Measure the ring free inside diameter (Df).
4. Measure the thickness (T).
5. Measure the radial wall (S).
6. Find the part in the chart.

DESCRIPTION

2-turn RS rings provide 360° groove contact and are designed for applications with medium thrust loads. These rings offer the greatest economy in price and size, and are able to handle a higher thrust capacity than the US series. See page 221 for thrust load comparisons.

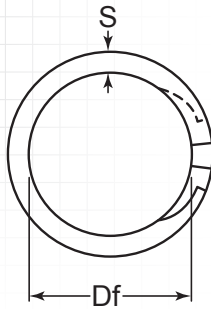

Ring Dimensions

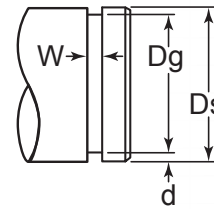
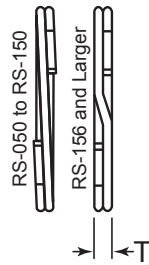

Groove Dimensions

Item #	Shaft Diameter		Groove Size				Ring Size & Weight						Thrust Load	
	Diameter		Width		Depth	Free Diameter		Thickness		Section		Ring Safety Factor of 3	Groove Safety Factor of 2	
	Ds	Dg	Tol.	W	Tol.	d	Df	Tol.	T	Tol.	S			Tol.
RS-050	.500"	.474"	±.002"	.030"		.013"	.467"		.025"	±.002"	.045"		2,000	460
RS-053	.531"	.505"	±.002"	.030"		.013"	.498"		.025"	±.002"	.045"		2,130	490
RS-055	.551"	.525"	±.002"	.030"		.013"	.518"		.025"	±.002"	.045"		2,210	510
RS-056	.562"	.536"	±.002"	.030"		.013"	.529"		.025"	±.002"	.045"		2,250	520
RS-059	.594"	.569"	±.003"	.030"		.013"	.561"		.025"	±.002"	.045"		2,380	550
RS-062	.625"	.594"	±.003"	.030"		.016"	.585"		.025"	±.002"	.055"		2,500	710
RS-065	.656"	.625"	±.003"	.030"		.016"	.617"		.025"	±.002"	.055"		2,630	740
RS-066	.669"	.638"	±.003"	.030"		.016"	.629"		.025"	±.002"	.055"		2,680	760
RS-068	.687"	.656"	±.003"	.030"		.016"	.647"		.025"	±.002"	.055"		2,750	780
RS-071	.718"	.687"	±.003"	.030"		.016"	.679"		.025"	±.002"	.055"		2,880	810
RS-075	.750"	.719"	±.003"	.036"		.016"	.710"	+ .000/ - .013"	.031"	±.002"	.065"		3,360	850
RS-078	.781"	.750"	±.003"	.036"		.016"	.741"		.031"	±.002"	.065"		3,500	880
RS-081	.812"	.781"	±.003"	.036"	+ .003/ - .000"	.016"	.771"		.031"	±.002"	.065"	+ .003/ - .005"	3,640	920
RS-084	.843"	.812"	±.003"	.036"		.016"	.803"		.031"	±.002"	.065"		3,780	950
RS-087	.875"	.838"	±.003"	.036"		.019"	.828"		.031"	±.002"	.065"		3,920	1,180
RS-090	.906"	.869"	±.003"	.036"		.019"	.860"		.031"	±.002"	.065"		4,060	1,220
RS-093	.937"	.900"	±.003"	.036"		.019"	.889"		.031"	±.002"	.065"		4,200	1,260
RS-096	.968"	.925"	±.003"	.042"		.021"	.916"		.037"	±.002"	.075"		5,180	1,440
RS-098	.984"	.941"	±.003"	.042"		.021"	.930"		.037"	±.002"	.075"		5,260	1,460
RS-100	1.000"	.957"	±.003"	.042"		.021"	.946"		.037"	±.002"	.075"		5,350	1,480
RS-102	1.023"	.980"	±.003"	.042"		.021"	.968"		.037"	±.002"	.075"		5,470	1,520
RS-103	1.031"	.988"	±.003"	.042"		.021"	.978"		.037"	±.002"	.075"		5,510	1,530
RS-106	1.062"	1.020"	±.004"	.042"		.021"	1.007"		.037"	±.002"	.075"		5,680	1,580
RS-109	1.093"	1.051"	±.004"	.042"		.021"	1.040"	+ .000/ - .015"	.037"	±.002"	.075"		5,840	1,620
RS-112	1.125"	1.083"	±.004"	.042"		.021"	1.070"		.037"	±.002"	.075"		6,020	1,670
RS-115	1.156"	1.114"	±.004"	.042"		.021"	1.102"		.037"	±.002"	.075"		6,180	1,720

Material: Carbon Spring Steel

SPIRAL RINGS

HUYETT.COM • 785-392-3017



EXTERNAL - 2-TURN MEDIUM DUTY

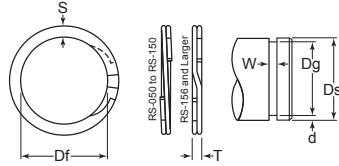

HOW TO IDENTIFY

1. Verify multi-turn design and appearance.
2. Measure the shaft diameter (Ds).
3. Measure the ring free inside diameter (Df).
4. Measure the thickness (T).
5. Measure the radial wall (S).
6. Find the part in the chart.

Item #	Shaft Diameter		Groove Size				Ring Size & Weight						Thrust Load	
			Diameter		Width		Depth	Free Diameter		Thickness		Section		Ring Safety Factor of 3
	Ds	Dg	Tol.	W	Tol.	d	Df	Tol.	T	Tol.	S	Tol.		
RS-118	1.188"	1.140"	±.004"	.048"		.024"	1.127"		.043"	±.002"	.085"		7,380	2,020
RS-121	1.218"	1.170"	±.004"	.048"		.024"	1.159"		.043"	±.002"	.085"		7,570	2,070
RS-125	1.250"	1.202"	±.004"	.048"		.024"	1.188"		.043"	±.002"	.085"		7,770	2,120
RS-128	1.281"	1.233"	±.004"	.048"		.024"	1.221"		.043"	±.002"	.085"		7,960	2,170
RS-131	1.312"	1.264"	±.004"	.048"		.024"	1.251"		.043"	±.002"	.095"		8,150	2,230
RS-134	1.343"	1.295"	±.004"	.048"		.024"	1.282"	+0.000/-0.015"	.043"	±.002"	.095"		8,350	2,280
RS-137	1.375"	1.323"	±.004"	.048"		.026"	1.308"		.043"	±.002"	.095"		8,540	2,530
RS-140	1.406"	1.354"	±.004"	.048"		.026"	1.340"		.043"	±.002"	.095"		8,740	2,580
RS-143	1.437"	1.385"	±.004"	.048"		.026"	1.370"		.043"	±.002"	.095"		8,930	2,640
RS-146	1.468"	1.416"	±.004"	.048"		.026"	1.402"		.043"	±.002"	.095"		9,120	2,700
RS-150	1.500"	1.448"	±.004"	.048"		.026"	1.433"		.043"	±.002"	.095"		9,320	2,760
RS-156	1.562"	1.507"	±.005"	.056"		.028"	1.490"		.049"	±.003"	.108"		10,100	3,090
RS-157	1.575"	1.520"	±.005"	.056"		.028"	1.503"		.049"	±.003"	.108"		10,190	3,120
RS-162	1.625"	1.566"	±.005"	.056"		.030"	1.549"		.049"	±.003"	.108"		10,510	3,450
RS-168	1.687"	1.628"	±.005"	.056"		.030"	1.610"		.049"	±.003"	.118"		10,910	3,580
RS-175	1.750"	1.691"	±.005"	.056"		.030"	1.673"		.049"	±.003"	.118"		11,310	3,710
RS-177	1.771"	1.708"	±.005"	.056"		.032"	1.690"		.049"	±.003"	.118"		11,450	4,010
RS-181	1.813"	1.749"	±.005"	.056"		.032"	1.730"	+0.000/-0.020"	.049"	±.003"	.118"		11,720	4,100
RS-187	1.875"	1.808"	±.005"	.056"		.034"	1.789"		.049"	±.003"	.128"	+0.003/-0.005"	12,120	4,510
RS-193	1.938"	1.871"	±.005"	.056"		.034"	1.844"		.049"	±.003"	.128"		12,530	4,660
RS-196	1.969"	1.902"	±.005"	.056"	+0.004/-0.000"	.034"	1.882"		.049"	±.003"	.128"		12,730	4,730
RS-200	2.000"	1.929"	±.005"	.056"		.035"	1.909"		.049"	±.003"	.128"		12,930	4,950
RS-206	2.062"	1.992"	±.006"	.056"		.035"	1.971"		.049"	±.003"	.128"		13,330	5,100
RS-212	2.125"	2.051"	±.006"	.056"		.037"	2.029"		.049"	±.003"	.128"		13,740	5,560
RS-215	2.156"	2.082"	±.006"	.056"		.037"	2.060"		.049"	±.003"	.138"		13,940	5,640
RS-216	2.165"	2.091"	±.006"	.056"		.037"	2.070"		.049"	±.003"	.138"		14,000	5,660
RS-218	2.188"	2.113"	±.006"	.056"		.037"	2.092"		.049"	±.003"	.138"		14,150	5,720
RS-225	2.250"	2.176"	±.006"	.056"		.037"	2.153"		.049"	±.003"	.138"		14,550	5,890
RS-231	2.312"	2.234"	±.006"	.056"		.039"	2.211"		.049"	±.003"	.138"		14,950	6,370
RS-236	2.362"	2.284"	±.006"	.056"		.039"	2.261"	+0.000/-0.025"	.049"	±.003"	.138"		15,270	6,510
RS-237	2.375"	2.297"	±.006"	.056"		.039"	2.273"		.049"	±.003"	.138"		15,360	6,550
RS-243	2.437"	2.355"	±.006"	.056"		.041"	2.331"		.049"	±.003"	.148"		15,760	7,060
RS-250	2.500"	2.418"	±.006"	.056"		.041"	2.394"		.049"	±.003"	.148"		16,160	7,250
RS-255	2.559"	2.473"	±.006"	.056"		.043"	2.449"		.049"	±.003"	.148"		16,550	7,780
RS-256	2.562"	2.476"	±.006"	.056"		.043"	2.452"		.049"	±.003"	.148"		16,560	7,790
RS-262	2.625"	2.539"	±.006"	.056"		.043"	2.514"		.049"	±.003"	.148"		16,970	7,980
RS-268	2.688"	2.597"	±.006"	.056"		.045"	2.572"		.049"	±.003"	.158"		17,380	8,550
RS-275	2.750"	2.660"	±.006"	.056"		.045"	2.635"		.049"	±.003"	.158"		17,780	8,750
RS-281	2.813"	2.722"	±.006"	.056"		.045"	2.696"		.049"	±.003"	.168"		18,190	8,950
RS-287	2.875"	2.781"	±.006"	.056"		.047"	2.755"	+0.000/-0.030"	.049"	±.003"	.168"	+0.004/-0.006"	18,590	9,550
RS-293	2.937"	2.843"	±.006"	.056"		.047"	2.817"		.049"	±.003"	.168"		18,990	9,760
RS-295	2.952"	2.858"	±.006"	.056"		.047"	2.831"		.049"	±.003"	.168"		19,090	9,810

FOR DETAILED SPECIFICATIONS AND TOLERANCES, VISIT HUYETT.COM.

Prices, materials, dimensions, tolerances, designs, and grades subject to change without notice. © 2017 G.L. Huyett

EXTERNAL – 2-TURN MEDIUM DUTY

MATERIAL

MATERIAL: CARBON SPRING STEEL



Item #	Shaft Diameter	Groove Size					Ring Size & Weight						Thrust Load		
		Diameter		Width		Depth	Free Diameter			Thickness		Section		Ring Safety Factor of 3	Groove Safety Factor of 2
		D _s	D _g	Tol.	W	Tol.	d	D _f	Tol.	T	Tol.	S	Tol.		
RS-300	3.000"	2.904"	±.006"	.068"		.048"	2.877"		.061"	±.003"	.168"		24,150	10,180	
RS-306	3.062"	2.966"	±.006"	.068"		.048"	2.938"		.061"	±.003"	.168"		24,650	10,390	
RS-312	3.125"	3.027"	±.006"	.068"		.049"	3.000"		.061"	±.003"	.178"		25,150	10,820	
RS-314	3.149"	3.051"	±.006"	.068"		.049"	3.023"		.061"	±.003"	.178"		25,350	10,910	
RS-318	3.187"	3.089"	±.006"	.068"		.049"	3.061"	+ .000/ - .030"	.061"	±.003"	.178"		25,650	11,040	
RS-325	3.250"	3.150"	±.006"	.068"		.05"	3.121"		.061"	±.003"	.178"		26,160	11,490	
RS-331	3.312"	3.208"	±.006"	.068"		.052"	3.180"		.061"	±.003"	.188"		26,660	12,170	
RS-334	3.343"	3.239"	±.006"	.068"		.052"	3.210"		.061"	±.003"	.188"		26,910	12,290	
RS-337	3.375"	3.271"	±.006"	.068"		.052"	3.242"		.061"	±.003"	.188"		27,170	12,410	
RS-343	3.437"	3.331"	±.006"	.068"		.053"	3.301"		.061"	±.003"	.188"		27,660	12,880	
RS-350	3.500"	3.394"	±.006"	.068"		.053"	3.363"		.061"	±.003"	.188"		28,170	13,110	
RS-354	3.543"	3.433"	±.006"	.068"		.055"	3.402"		.061"	±.003"	.198"		28,520	13,770	
RS-356	3.562"	3.452"	±.006"	.068"		.055"	3.422"		.061"	±.003"	.198"		28,670	13,850	
RS-362	3.625"	3.515"	±.006"	.068"		.055"	3.483"		.061"	±.003"	.198"		29,180	14,090	
RS-368	3.687"	3.575"	±.006"	.068"		.056"	3.543"		.061"	±.003"	.198"		29,680	14,600	
RS-374	3.740"	3.628"	±.006"	.068"		.056"	3.597"		.061"	±.003"	.198"		30,100	14,800	
RS-375	3.750"	3.638"	±.006"	.068"		.056"	3.606"		.061"	±.003"	.198"		30,180	14,840	
RS-381	3.812"	3.700"	±.006"	.068"		.056"	3.668"		.061"	±.003"	.198"		30,680	15,090	
RS-387	3.875"	3.757"	±.006"	.068"		.059"	3.724"	+ .000/ - .040"	.061"	±.003"	.208"		31,190	16,160	
RS-393	3.938"	3.820"	±.006"	.068"		.059"	3.784"		.061"	±.003"	.208"		31,700	16,420	
RS-400	4.000"	3.876"	±.006"	.068"	+ .005/ - .000"	.062"	3.842"		.061"	±.003"	.218"	+ .004/ - .006"	32,200	17,530	
RS-406	4.063"	3.939"	±.006"	.068"		.062"	3.906"		.061"	±.003"	.218"		32,700	17,810	
RS-412	4.125"	4.000"	±.006"	.068"		.062"	3.967"		.061"	±.003"	.218"		33,200	18,080	
RS-413	4.134"	4.010"	±.006"	.068"		.062"	3.975"		.061"	±.003"	.218"		33,270	18,120	
RS-418	4.188"	4.058"	±.006"	.068"		.065"	4.030"		.061"	±.003"	.218"		33,710	19,240	
RS-425	4.250"	4.120"	±.006"	.068"		.065"	4.084"		.061"	±.003"	.228"		34,210	19,530	
RS-431	4.312"	4.182"	±.006"	.068"		.065"	4.147"		.061"	±.003"	.228"		34,710	19,810	
RS-433	4.331"	4.200"	±.006"	.068"		.065"	4.164"		.061"	±.003"	.228"		34,860	19,900	
RS-437	4.375"	4.245"	±.006"	.068"		.065"	4.208"		.061"	±.003"	.228"		35,210	20,100	
RS-443	4.437"	4.307"	±.006"	.068"		.065"	4.271"		.061"	±.003"	.228"		35,710	20,390	
RS-450	4.500"	4.364"	±.006"	.068"		.068"	4.326"		.061"	±.003"	.238"		36,220	21,630	
RS-456	4.562"	4.422"	±.006"	.079"		.070"	4.384"		.072"	±.004"	.250"		43,340	22,570	
RS-462	4.625"	4.485"	±.006"	.079"		.070"	4.447"		.072"	±.004"	.250"		43,940	22,890	
RS-468	4.687"	4.547"	±.006"	.079"		.070"	4.508"		.072"	±.004"	.250"		44,530	23,190	
RS-472	4.724"	4.584"	±.006"	.079"		.070"	4.546"	+ .000/ - .040"	.072"	±.004"	.250"		44,880	23,370	
RS-475	4.750"	4.610"	±.006"	.079"		.070"	4.571"		.072"	±.004"	.250"		45,130	23,500	
RS-481	4.812"	4.672"	±.006"	.079"		.070"	4.633"		.072"	±.004"	.250"		45,720	23,810	
RS-487	4.875"	4.735"	±.006"	.079"		.070"	4.695"		.072"	±.004"	.250"		46,310	24,120	
RS-493	4.937"	4.797"	±.006"	.079"		.070"	4.757"		.072"	±.004"	.250"		46,900	24,430	
RS-500	5.000"	4.856"	±.006"	.079"		.072"	4.820"		.072"	±.004"	.250"		47,500	25,450	
RS-511	5.118"	4.974"	±.006"	.079"		.072"	4.934"		.072"	±.004"	.250"		48,620	26,050	
RS-512	5.125"	4.981"	±.006"	.079"		.072"	4.939"		.072"	±.004"	.250"		48,690	26,080	

SPIRAL RINGS

HUYETT.COM • 785-392-3017



EXTERNAL - 2-TURN MEDIUM DUTY

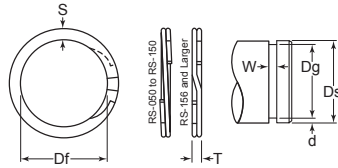

MATERIAL

MATERIAL: CARBON SPRING STEEL

Item #	Shaft Diameter	Groove Size					Ring Size & Weight						Thrust Load	
		Diameter		Width		Depth	Free Diameter		Thickness		Section		Ring Safety Factor of 3	Groove Safety Factor of 2
		D _s	D _g	Tol.	W	Tol.	d	D _f	Tol.	T	Tol.	S		
RS-525	5.250"	5.107"	±.007"	.079"	+.005/ -.000"	.072"	5.064"	+.000/ -.050"	.072"	±.004"	.250"	+.004/ -.006"	49,880	26,720
RS-537	5.375"	5.228"	±.007"	.079"		.074"	5.187"		.072"	±.004"	.250"		51,060	28,120
RS-550	5.500"	5.353"	±.007"	.079"		.074"	5.308"		.072"	±.004"	.250"		52,250	28,770
RS-551	5.511"	5.364"	±.007"	.079"		.074"	5.320"		.072"	±.004"	.250"		52,360	28,830
RS-562	5.625"	5.478"	±.007"	.079"		.074"	5.433"		.072"	±.004"	.250"		53,440	29,420
RS-575	5.750"	5.597"	±.007"	.079"		.077"	5.550"		.072"	±.004"	.250"		54,630	31,300
RS-587	5.875"	5.722"	±.007"	.079"		.077"	5.674"		.072"	±.004"	.250"		55,810	31,980
RS-590	5.905"	5.752"	±.007"	.079"		.077"	5.705"		.072"	±.004"	.250"		56,100	32,140
RS-600	6.000"	5.847"	±.007"	.079"		.077"	5.798"		.072"	±.004"	.250"		57,000	32,660
RS-612	6.125"	5.953"	±.008"	.094"		.086"	5.903"		.086"	±.004"	.312"		69,500	37,230
RS-625	6.250"	6.078"	±.008"	.094"	.086"	6.026"	.086"	±.004"	.312"	70,920	37,990			
RS-629	6.299"	6.127"	±.008"	.094"	.086"	6.076"	.086"	±.004"	.312"	71,480	38,290			
RS-637	6.375"	6.203"	±.008"	.094"	.086"	6.152"	.086"	±.004"	.312"	72,340	38,750			
RS-650	6.500"	6.328"	±.008"	.094"	.086"	6.274"	.086"	±.004"	.312"	73,760	39,510			
RS-662	6.625"	6.443"	±.008"	.094"	.091"	6.390"	.086"	±.004"	.312"	75,180	42,620			
RS-675	6.750"	6.568"	±.008"	.094"	.091"	6.513"	.086"	±.004"	.312"	76,600	43,420			
RS-687	6.875"	6.693"	±.008"	.094"	.091"	6.638"	.086"	±.004"	.312"	78,010	44,220			
RS-700	7.000"	6.818"	±.008"	.094"	.091"	6.761"	.086"	±.004"	.312"	79,430	45,030			
RS-712	7.125"	6.933"	±.008"	.094"	.096"	6.877"	.086"	±.004"	.312"	80,850	48,350			
RS-725	7.250"	7.058"	±.008"	.094"	.096"	6.999"	.086"	±.004"	.312"	82,270	49,200			
RS-737	7.375"	7.183"	±.008"	.094"	.096"	7.125"	.086"	±.004"	.312"	83,690	50,050			
RS-750	7.500"	7.308"	±.008"	.094"	.096"	7.250"	.086"	±.004"	.312"	85,110	50,890			
RS-762	7.625"	7.423"	±.008"	.094"	.101"	7.363"	.086"	±.004"	.312"	86,520	54,440			
RS-775	7.750"	7.548"	±.008"	.094"	.101"	7.486"	.086"	±.004"	.312"	87,940	55,330			
RS-787	7.875"	7.673"	±.008"	.094"	.101"	7.611"	.086"	±.004"	.312"	89,360	56,220			
RS-800	8.000"	7.798"	±.008"	.094"	.101"	7.734"	.086"	±.004"	.312"	90,780	57,110			
RS-825	8.250"	8.038"	±.008"	.094"	.106"	7.972"	.086"	±.004"	.375"	93,620	61,820			
RS-850	8.500"	8.288"	±.008"	.094"	.106"	8.220"	.086"	±.004"	.375"	96,450	63,690			
RS-875	8.750"	8.528"	±.008"	.094"	.111"	8.459"	.086"	±.004"	.375"	99,290	68,650			
RS-900	9.000"	8.778"	±.008"	.094"	.111"	8.707"	.086"	±.004"	.375"	102,130	70,620			
RS-925	9.250"	9.018"	±.008"	.094"	.116"	8.945"	.086"	±.004"	.375"	104,960	75,850			
RS-950	9.500"	9.268"	±.008"	.094"	.116"	9.194"	.086"	±.004"	.375"	107,800	77,900			
RS-975	9.750"	9.508"	±.008"	.094"	.121"	9.432"	.086"	±.004"	.375"	110,640	83,390			
RS-1000	10.000"	9.758"	±.008"	.094"	.121"	9.680"	.086"	±.004"	.375"	113,470	85,530			
RS-1025	10.250"	9.998"	±.008"	.094"	.126"	9.918"	.086"	±.004"	.375"	116,310	91,290			
RS-1050	10.500"	1.248"	±.008"	.094"	.126"	1.166"	.086"	±.004"	.375"	119,150	93,520			
RS-1075	10.750"	1.488"	±.008"	.094"	.131"	1.405"	.086"	±.004"	.375"	121,990	99,540			
RS-1100	11.000"	1.738"	±.008"	.094"	.131"	1.653"	.086"	±.004"	.375"	124,820	101,860			

FOR DETAILED SPECIFICATIONS AND TOLERANCES, VISIT HUYETT.COM.

Prices, materials, dimensions, tolerances, designs, and grades subject to change without notice. © 2017 G.L. Huyett