

Crosby® / Bullard® Golden Gate® Hooks

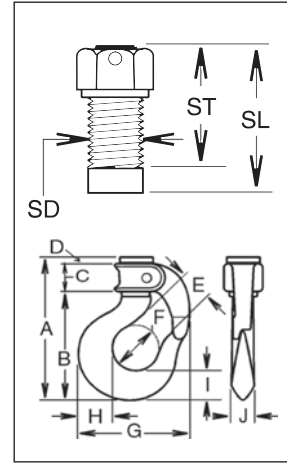

Standard Length SHANK HOOKS

- For use on existing load blocks, with standard shank length.
- No.'s 2 through 12 style hooks are threaded approximately 80% of shank length.
 - BL-D - with self-closing gate.
 - BL-B - with manual-closing gate.
- Use in corrosive environment requires shank and nut inspection in accordance with ASME B30.9-1.10.4(b)(5)(c)2014.
- Crosby®/Bullard® Hooks incorporate two types of strategically placed markings forged into the product which address two (2) **QUIC-CHECK®** features:
 - Angle Indicators and Deformation Indicators (see the Bullard® **QUIC-CHECK®** table at bottom of page 129 for detailed definition).



Standard Length Shank Hooks

Hook Size	BL-D Stock No.	BL-B Stock No.	Gate Type	Working Load Limit (T)*	Weight Each (lbs.)	Dimensions (in)												
						A	B	C	D	E	F	G	H	I	J	SD	SL	ST
2	1050606	1050408	PIN-LOK	1.00	1.1	4.12	3.00	.93	.16	.97	1.25	2.88	.81	.75	.56	.50	.91	.59
3	1050617	1050419	PIN-LOK	1.40	1.3	4.50	3.31	.94	.22	1.06	1.38	3.19	.94	.84	.63	.56	1.25	.75
4	1050628	1050430	PIN-LOK	1.70	1.7	4.88	3.63	1.00	.22	1.13	1.50	3.63	1.16	1.00	.75	.63	1.31	1.19
5	1050639	1050441	ROLLOX	2.30	2.5	5.63	4.12	1.23	.25	1.25	1.64	4.09	1.31	1.12	.84	.75	1.31	1.00
6	1050650	1050452	ROLLOX	4.00	3.5	6.23	4.70	1.25	.25	1.39	1.64	4.56	1.57	1.34	.97	.88	1.69	1.16
7	1050661	1050463	ROLLOX	4.20	5.2	6.61	5.21	1.12	.25	1.50	2.00	4.94	1.63	1.44	1.13	1.00	1.81	1.38
8	1050672	1050474	ROLLOX	5.50	7.1	7.17	5.80	1.06	.28	1.75	2.25	5.84	2.00	1.65	1.23	1.13	2.06	1.50
9	1050683	1050485	ROLLOX	7.20	9.5	7.85	6.45	1.06	.31	1.88	2.50	6.50	2.06	1.81	1.38	1.25	2.44	1.81
11	1050694	1050496	TIP-LOK	9.20	15.6	9.62	8.00	1.25	.31	2.25	3.00	7.56	2.63	2.25	1.62	1.50	2.69	1.88
12	1050705	1050507	TIP-LOK	12.30	21.0	10.53	8.84	1.25	.38	2.50	3.25	8.69	2.94	2.59	1.94	1.63	2.88	2.13
13	1050716	1050518	TIP-LOK	15.00	30.0	11.23	9.54	1.25	.38	3.00	3.75	9.63	3.28	2.75	1.94	1.75	3.50	2.20
14	1050727	1050529	TIP-LOK	18.50	40.0	12.60	10.75	1.41	.38	3.38	4.25	11.00	3.50	2.97	2.38	2.00	3.75	2.38

*Ultimate Load is 4 times the Working Load Limit. If a drawing is not available, complete a Crosby/Bullard HOOK DATA FORM. Hook No.'s 2 through 12 style hooks are threaded approximately 80% of the shank length.



BL-PKU DOUBLE ENDED HOOK

- Makes Conductor Tensioning faster and easier.
- Suitable for frequent rotation under load.
- Use in corrosive environment requires shank and nut inspection in accordance with ASME B30.9-1.10.4(b)(5)(c)2014.
- Crosby®/Bullard® Hooks incorporate two types of strategically placed markings forged into the product which address two (2) **QUIC-CHECK®** features:
 - Angle Indicators and Deformation Indicators (see the Bullard® **QUIC-CHECK®** table at bottom of page 129 for detailed definition).

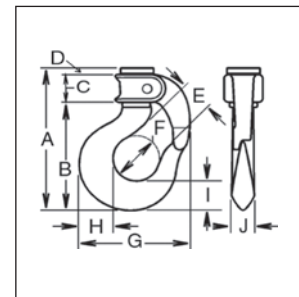

Double Ended Hook (Available only with Manual Closing Gate.)

Hook Size and Type	BL-PKU Stock No.	Gate Type	Working Load Limit (T)*	Weight Each (lbs.)	Dimensions (in)											
					A	B	C	D	E	F	G	H	I	J		
4PKU	1051805	PIN-LOK	1.7	5.0	4.88	3.63	1.00	.22	1.13	1.50	3.63	1.16	1.00	.75		
5PKU	1051816	ROLLOX	2.3	8.0	5.63	4.12	1.23	.25	1.25	1.64	4.09	1.31	1.12	.84		
6PKU	1051827	ROLLOX	4.0	11.0	6.23	4.70	1.25	.25	1.39	1.64	4.56	1.57	1.34	.97		

*Ultimate Load is 4 times the Working Load Limit.