

# Mounted Ball Bearings *Browning*

Mtd. Ball Bearings

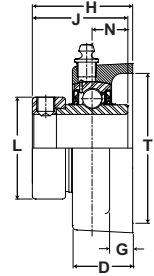

- Duty:** Standard
- Rolling Elements:** Ball
- Housing:** Cast Iron Two Bolt Flange
- Self Alignment:** +/- 1.5 Degrees
- Lock:** Eccentric
- Seal:** Contact and Flinger
- Temperature:** -20° to 200°F

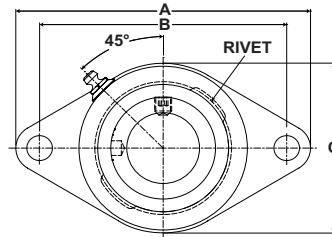

## VF2E 200 Series Standard Duty Two Bolt Flanges - Eccentric Locking

| Bore Diameter<br>inch | Part No.  | Bearing Insert No. | Basic Dynamic Rating<br>lb/N | Dimensions inch / mm |         |        |         |       |         |         |        |        |            | Bolt Size | Unit Wt.<br>lb/kg |
|-----------------------|-----------|--------------------|------------------------------|----------------------|---------|--------|---------|-------|---------|---------|--------|--------|------------|-----------|-------------------|
|                       |           |                    |                              | A                    | B       | C      | D       | G     | H       | J       | L      | N      | T<br>Cored |           |                   |
| 1/2                   | VF2E-208  | VE-208             | 2108                         | 3 7/8                | 3       | 2 1/8  | 1 1/32  | 1/2   | 1 43/64 | 1 15/32 | 1 3/16 | 35/64  | 1 3/4      | 3/8       | 1.0               |
| 5/8                   | VF2E-210  | VE-210             | 9377                         | 98.4                 | 76.2    | 54.0   | 26.2    | 12.7  | 42.5    | 37.3    | 30.2   | 13.9   | 44.5       |           | .45               |
| 3/4                   | VF2E-212  | VE-212             | 2611<br>11614                | 4 13/32              | 3 17/32 | 2 1/2  | 1 5/64  | 1/2   | 1 51/64 | 1 23/32 | 1 5/16 | 43/64  | 2          | 3/8       | 1.1<br>.50        |
| 7/8                   | VF2E-214  | VE-214             | 2801                         | 4 7/8                | 3 57/64 | 2 3/4  | 1 5/64  | 17/32 | 1 13/16 | 1 3/4   | 1 1/2  | 11/16  | 2 5/16     |           | 7/16              |
| 15/16                 | VF2E-215  | VE-215             | 12459                        | 123.8                | 98.8    | 69.9   | 27.4    | 13.5  | 46.0    | 44.5    | 38.1   | 17.5   | 58.7       | .68       |                   |
| 1                     | VF2E-216  | VE-216             |                              |                      |         |        |         |       |         |         |        |        |            |           |                   |
| 1 1/8                 | VF2E-218  | VE-218             | 4381                         | 5 9/16               | 4 19/32 | 3 1/8  | 1 13/64 | 17/32 | 2       | 1 29/32 | 1 3/4  | 23/32  | 2 3/4      | 7/16      | 2.1               |
| 1 3/16                | VF2E-219  | VE-219             | 19487                        | 141.3                | 116.7   | 79.4   | 30.6    | 13.5  | 50.8    | 48.4    | 44.5   | 18.3   | 69.9       |           | .95               |
| 1 1/4                 | VF2E-220S | VE-220S            |                              |                      |         |        |         |       |         |         |        |        |            |           |                   |
| 1 1/4                 | VF2E-220  | VE-220             | 5782                         | 6 1/8                | 5 1/8   | 3 5/8  | 1 1/4   | 5/8   | 2 1/8   | 2 1/64  | 2 3/16 | 3/4    | 3 3/16     | 1/2       | 2.9               |
| 1 3/8                 | VF2E-222  | VE-222             | 25718                        | 155.6                | 130.2   | 92.1   | 31.8    | 15.9  | 54.0    | 51.2    | 55.6   | 19.1   | 81.0       |           | 1.32              |
| 1 7/16                | VF2E-223  | VE-223             |                              |                      |         |        |         |       |         |         |        |        |            |           |                   |
| 1 1/2                 | VF2E-224  | VE-224             | 7340<br>32648                | 6 3/4                | 5 21/32 | 4 1/8  | 1 13/32 | 5/8   | 2 5/16  | 2 7/32  | 2 3/8  | 27/32  | 3 1/2      | 1/2       | 3.8<br>1.72       |
| 1 5/8                 | VF2E-226  | VE-226             | 7901                         | 7 1/16               | 5 27/32 | 4 3/8  | 1 13/32 | 5/8   | 2 5/16  | 2 7/32  | 2 1/2  | 27/32  | 3 3/4      |           | 9/16              |
| 1 11/16               | VF2E-227  | VE-227             | 35144                        | 179.4                | 148.4   | 111.1  | 35.7    | 15.9  | 58.7    | 56.4    | 63.5   | 21.4   | 95.3       | 1.77      |                   |
| 1 3/4                 | VF2E-228  | VE-228             |                              |                      |         |        |         |       |         |         |        |        |            |           |                   |
| 1 15/16               | VF2E-231  | VE-231             | 7889<br>35090                | 7 7/16               | 6 3/16  | 4 9/16 | 1 39/64 | 11/16 | 2 5/8   | 2 15/32 | 2 3/4  | 31/32  | 4          | 9/16      | 4.8<br>2.18       |
| 2                     | VF2E-232  | VE-232             | 9752                         | 8 1/2                | 7 1/4   | 5 1/4  | 1 49/64 | 13/16 | 2 31/32 | 2 13/16 | 3      | 1 3/32 | 4 1/4      |           | 5/8               |
| 2 7/16                | VF2E-235  | VE-235             | 43377                        | 215.9                | 184.2   | 133.4  | 44.8    | 20.6  | 75.4    | 71.4    | 76.2   | 27.8   | 108.0      | 2.81      |                   |
| 2 1/4                 | VF2E-236  | VE-236             | 11789                        | 9 1/4                | 7 15/16 | 5 7/16 | 1 31/32 | 13/16 | 3 1/4   | 3 1/16  | 3 3/8  | 1 7/32 | 4 3/4      | 5/8       | 9.6               |
| 2 7/16                | VF2E-239  | VE-239             | 52437                        | 235.0                | 201.6   | 138.1  | 50.0    | 20.6  | 82.6    | 77.8    | 85.7   | 31.0   | 120.7      |           | 4.35              |