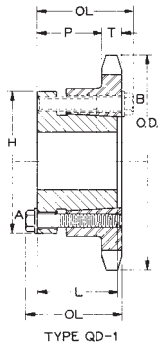

Table No. 1 Steel Sprockets with Q-D® Bushings



Part No.	Bushing	Bore Range	DIAMETERS		Type	No. Teeth	DIMENSIONS					Wt. Less Bushing
			Outside	Pitch			T Nom.	OL	L	P	H	
35JA19*	JA	1/2-1 1/4"	2.47"	2.278"	QD-1	19	.168"	1 5/16"	1"	63/64"	2"	.28
35JA20	JA	1/2-1 1/4"	2.59	2.397	QD-1	20	.168	1 5/16	1	63/64	2	.37
35JA21	JA	1/2-1 1/4"	2.71	2.516	QD-1	21	.168	1 5/16	1	63/64	2	.41
35JA22	JA	1/2-1 1/4"	2.83	2.635	QD-1	22	.168	1 5/16	1	63/64	2	.43
35JA23	JA	1/2-1 1/4"	2.95	2.745	QD-1	23	.168	1 5/16	1	63/64	2	.45
35JA24	JA	1/2-1 1/4"	3.07	2.873	QD-1	24	.168	1 5/16	1	63/64	2	.48
35JA25	JA	1/2-1 1/4"	3.19	2.992	QD-1	25	.168	1 5/16	1	63/64	2	.50
35JA26	JA	1/2-1 1/4"	3.31	3.111	QD-1	26	.168	1 5/16	1	63/64	2	.53
35JA27	JA	1/2-1 1/4"	3.43	3.230	QD-1	27	.168	1 5/16	1	63/64	2	.55
35JA28	JA	1/2-1 1/4"	3.55	3.349	QD-1	28	.168	1 5/16	1	63/64	2	.58
35JA30	JA	1/2-1 1/4"	3.79	3.588	QD-1	30	.168	1 5/16	1	63/64	2	.64
35JA32	JA	1/2-1 1/4"	4.03	3.826	QD-1	32	.168	1 5/16	1	63/64	2	.71
35JA35	JA	1/2-1 1/4"	4.39	4.183	QD-1	35	.168	1 5/16	1	63/64	2	.81
35SH36	SH	1/2-1 5/8"	4.51	4.303	QD-1	36	.168	1 23/32	1 5/16	1 21/64	2 11/16	1.34
35SH40	SH	1/2-1 5/8"	4.99	4.780	QD-1	40	.168	1 23/32	1 5/16	1 21/64	2 11/16	1.48
35SH42	SH	1/2-1 5/8"	5.23	5.018	QD-1	42	.168	1 23/32	1 5/16	1 21/64	2 11/16	1.56
35SH45	SH	1/2-1 5/8"	5.59	5.376	QD-1	45	.168	1 23/32	1 5/16	1 21/64	2 11/16	1.69
35SH48	SH	1/2-1 5/8"	5.95	5.734	QD-1	48	.168	1 23/32	1 5/16	1 21/64	2 11/16	1.82
35SH54	SH	1/2-1 5/8"	6.66	6.449	QD-1	54	.168	1 23/32	1 5/16	1 21/64	2 11/16	2.11
35SH60	SH	1/2-1 5/8"	7.38	7.165	QD-1	60	.168	1 23/32	1 5/16	1 21/64	2 11/16	2.44
35SH70	SH	1/2-1 5/8"	8.58	8.358	QD-1	70	.168	1 23/32	1 5/16	1 21/64	2 11/16	3.06
35SH72	SH	1/2-1 5/8"	8.81	8.597	QD-1	72	.168	1 23/32	1 5/16	1 21/64	2 11/16	3.20
35SH80	SH	1/2-1 5/8"	9.77	9.552	QD-1	80	.168	1 23/32	1 5/16	1 21/64	2 11/16	3.78
35SH84	SH	1/2-1 5/8"	10.25	10.029	QD-1	84	.168	1 23/32	1 5/16	1 21/64	2 11/16	4.09
35SH96	SH	1/2-1 5/8"	11.68	11.461	QD-1	96	.168	1 23/32	1 5/16	1 21/64	2 11/16	5.1
35SH112	SH	1/2-1 5/8"	13.59	13.371	QD-1	112	.168	1 23/32	1 5/16	1 21/64	2 11/16	6.7

*Bushing mounts with capscrew heads on "A" side only.

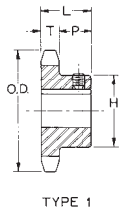

Table No. 2 Finished Bore Single Sprockets

Part No.	DIAMETERS		No. Teeth	Type	STOCK BORES MARKED "X"										DIMENSIONS			Wt. Lbs.
	Outside	Pitch			3/8"	1/2"	5/8"	3/4"	7/8"	1"	1 1/8"	1 3/16"	1 1/4"	T Nom.	L Max.	P		
STOCK Steel Sprockets																		
H359	1.25"	1.069"	9	1	x	-	-	-	-	-	-	-	.168"	3/4"	37/64	.1		
H3510	1.37	1.214	10	1	x	x	x	-	-	-	-	-	.168	3/4	37/64	.1		
H3511	1.50	1.331	11	1	x	x	x	x	-	-	-	-	.168	3/4	37/64	.2		
H3512	1.62	1.449	12	1	-	x	x	x	-	-	-	-	.168	3/4	37/64	.2		
H3513	1.75	1.567	13	1	-	x	x	x	-	-	-	-	.168	3/4	37/64	.3		
H3514	1.87	1.685	14	1	-	x	x	x	-	-	-	-	.168	3/4	37/64	.3		
H3515	1.99	1.804	15	1	-	x	x	x	x	x	-	-	.168	3/4	37/64	.3		
H3516	2.10	1.922	16	1	-	x	x	x	x	x	-	-	.168	3/4	37/64	.4		
H3517	2.23	2.041	17	1	-	x	x	x	x	x	-	-	.168	3/4	37/64	.4		
H3518	2.35	2.159	18	1	-	x	x	x	x	x	-	-	.168	3/4	37/64	.5		
H3519	2.47	2.278	19	1	-	x	x	x	-	x	-	-	.168	3/4	37/64	.5		
H3520	2.59	2.397	20	1	-	x	x	x	-	x	-	-	.168	3/4	37/64	.7		
H3521	2.70	2.516	21	1	-	x	x	x	-	x	-	-	.168	27/32	43/64	.8		
H3522	2.83	2.635	22	1	-	x	x	x	-	x	-	-	.168	27/32	43/64	.8		
H3523	2.95	2.754	23	1	-	x	x	x	-	x	-	-	.168	27/32	43/64	.9		
H3524	3.07	2.873	24	1	-	x	x	x	-	x	-	-	.168	27/32	43/64	1.1		
H3525	3.19	2.992	25	1	-	x	x	x	-	x	-	-	.168	27/32	43/64	1.2		
H3526	3.31	3.111	26	1	-	-	x	x	x	x	x	x	.168	27/32	43/64	1.3		
H3528	3.55	3.349	28	1	-	-	x	x	x	x	x	x	.168	27/32	43/64	1.3		
H3530	3.79	3.588	30	1	-	-	x	x	x	x	x	x	.168	27/32	43/64	1.4		
3532	4.03	3.862	32	1	-	-	x	x	-	x	-	-	.168	27/32	43/64	1.5		
3536	4.51	4.303	36	1	-	-	x	x	-	x	-	-	.168	27/32	43/64	1.8		
3540	4.99	4.780	40	1	-	-	x	x	-	x	-	-	.168	27/32	43/64	2.0		
3542	5.23	5.018	42	1	-	-	-	-	-	x	-	-	.168	27/32	43/64	2.2		
3545	5.59	5.376	45	1	-	-	x	x	-	-	-	-	.168	27/32	43/64	2.4		
3548	5.95	5.734	48	1	-	-	-	x	-	-	-	-	.168	27/32	43/64	2.6		
3560	7.38	7.165	60	1	-	-	x	x	-	x	-	-	.168	27/32	43/64	3.4		

All Stock Finished Bore Sprockets are furnished with Standard Keyway on Centerline of Tooth and Hollow Head Setscrew over Keyway, except 1/2" bores and smaller which have setscrews only. Sprockets with HARDENED TEETH have an additional Setscrew at 90° to Keyway.