

TYPE DB

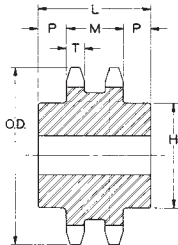

TYPE DC

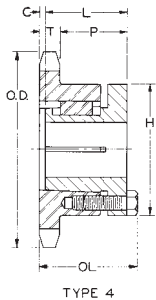

TYPE 4

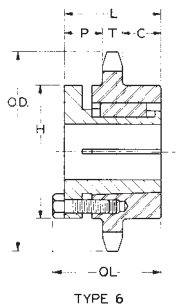

TYPE 6

Table No. 1

Steel Minimum Bore Double Sprockets

Part No.	DIAMETERS		No. Teeth	Type	BORE		DIMENSIONS					Wt. Lbs.
	Outside	Pitch			Stock	Max.*	T	M	L Max.	P	H	
D140B13	8.15"	7.313"	13	DB	1 1/2"	2 15/16"	.894"	2.818"	3 3/4"	15/16"	5"	31.0
D140B14	8.72	7.864	14	DB	1 1/2	3 3/8	.894	2.818	3 3/4	15/16	5 1/2	36.9
D140B15	9.28	8.417	15	DB	1 1/2	4 3/8	.894	2.818	3 3/4	15/16	6 1/2	44.6
D140B16	9.85	8.970	16	DB	1 1/2	4 3/4	.894	2.818	4	1 3/16	7	55.1
D140B17	10.41	9.524	17	DB	1 1/2	4 3/4	.894	2.818	4	1 3/16	7 1/4	61.0
D140B18	10.98	10.078	18	DB	1 1/2	4 3/4	.894	2.818	4	1 3/16	7 1/4	67.4
D140B19	11.54	10.632	19	DB	1 1/2	4 3/4	.894	2.818	4	1 3/16	7 1/4	74.1
D140B20	12.10	11.187	20	DB	1 1/2	4 3/4	.894	2.818	4	1 3/16	7 1/4	81.2
D140B21	12.66	11.742	21	DB	1 1/2	4 3/4	.894	2.818	4	1 3/16	7 1/4	88.7
D140B22	13.22	12.297	22	DB	1 1/2	4 3/4	.894	2.818	4	1 3/16	7 1/4	96.6
D140B23	13.78	12.852	23	DB	1 1/2	4 3/4	.894	2.818	4	1 3/16	7 1/4	105
D140B24	14.34	13.407	24	DB	1 1/2	4 3/4	.894	2.818	4	1 3/16	7 1/4	114
D140B25	14.90	13.963	25	DB	1 1/2	4 3/4	.894	2.818	4	1 3/16	7 1/4	123
D140B26	15.46	14.518	26	DB	1 1/2	4 3/4	.894	2.818	4	1 3/16	7 1/4	132
D140C35	20.49	19.523	35	DC	1 1/2	5	.894	2.818	6	1 19/32	7 1/2	260
D140C45	26.08	25.087	45	DC	1 1/2	5	.894	2.818	6	1 19/32	7 1/2	410
D140C60	34.44	33.438	60	DC	1 1/2	6 7/16	.894	2.818	6 1/4	1 19/32	9 3/8	410

* Maximum bores shown will accommodate standard keyway and setscrew over keyway. Slightly larger bores are possible with no keyway, shallow keyway or setscrew at angle to keyway. These sprockets are furnished with minimum bore and no keyway. They can be rebored to size, keywayed and setscrewed for a reasonable extra charge.

Sprockets for No. 160, 2" Pitch ANSI Chain

Table No. 2

Steel Single Sprockets with Browning Split Taper® Bushings

Part No.	Bushing	Bore Range	DIAMETERS		No. Teeth	Type	DIMENSIONS						Wt. Less Bushing
			Outside	Pitch			T Nom.	OL	L	P	C	H	
H160R11	R1	1 1/8 - 3 3/4"	8.01"	7.099"	11	4	1.156"	3 13/32"	2 7/8"	1 31/32"	1/4"	5 3/8"	10.8
H160R12	R1	1 1/8 - 3 3/4	8.66	7.727	12	4	1.156	3 9/64	2 7/8	1 3/4	1/16	5 3/8	14.2
H160R13	R1	1 1/8 - 3 3/4	9.31	8.357	13	4	1.156	3 9/64	2 7/8	1 3/4	1/16	5 3/8	15.5
H160R14	R1	1 1/8 - 3 3/4	9.96	8.988	14	4	1.156	3 9/64	2 7/8	1 3/4	1/16	5 3/8	18.5
H160R15	R1	1 1/8 - 3 3/4	10.61	9.620	15	4	1.156	3 9/64	2 7/8	1 3/4	1/16	5 3/8	21.6
H160R16	R1	1 1/8 - 3 3/4	11.25	10.252	16	4	1.156	3 9/64	2 7/8	1 3/4	1/16	5 3/8	25.0
H160R17	R1	1 1/8 - 3 3/4	11.90	10.882	17	4	1.156	3 9/64	2 7/8	1 3/4	1/16	5 3/8	28.0
H160R18	R1	1 1/8 - 3 3/4	12.54	11.518	18	4	1.156	3 9/64	2 7/8	1 3/4	1/16	5 3/8	31.9
H160R19	R1	1 1/8 - 3 3/4	13.19	12.151	19	4	1.156	3 9/64	2 7/8	1 3/4	1/16	5 3/8	35.9
H160R20	R2	1 3/8 - 3 5/8	13.83	12.785	20	6	1.156	5 5/32	4 7/8	1 23/32	2	5 3/8	51.0
H160R21	R2	1 3/8 - 3 5/8	14.47	13.419	21	6	1.156	5 5/32	4 7/8	1 23/32	2	5 3/8	56.0
H160R22	R2	1 3/8 - 3 5/8	15.11	14.053	22	6	1.156	5 5/32	4 7/8	1 23/32	2	5 3/8	60.0
H160R23	R2	1 3/8 - 3 5/8	15.75	14.688	23	6	1.156	5 5/32	4 7/8	1 23/32	2	5 3/8	65.0
H160R24	R2	1 3/8 - 3 5/8	16.39	15.323	24	6	1.156	5 5/32	4 7/8	1 23/32	2	5 3/8	71.5
H160R25	R2	1 3/8 - 3 5/8	17.03	15.958	25	6	1.156	5 5/32	4 7/8	1 23/32	2	5 3/8	74.0
H160R26	R2	1 3/8 - 3 5/8	17.67	16.593	26	6	1.156	5 5/32	4 7/8	1 23/32	2	5 3/8	79.0
H120S26	S2	1 7/8 - 4 3/16	17.67	16.593	26	6	1.156	7 1/8	6 3/4	2 23/32	2 7/8	6 3/8	79.0
H160R28	R2	1 3/8 - 3 5/8	18.95	17.863	28	6	1.156	5 5/32	4 7/8	1 23/32	2	5 3/8	99.8
H160S28	S2	1 7/8 - 4 3/16	18.95	17.863	28	6	1.156	7 1/8	6 3/4	2 23/32	2 7/8	6 3/8	99.8
H160R30	R2	1 3/8 - 3 5/8	20.23	19.134	30	6	1.156	5 5/32	4 7/8	1 23/32	2	5 3/8	106
H160S30	S2	1 7/8 - 4 3/16	20.23	19.134	30	6	1.156	7 1/8	6 3/4	2 23/32	2 7/8	6 3/8	115
160S35	S2	1 7/8 - 4 3/16	23.42	22.312	35	6	1.156	7 1/8	6 3/4	2 23/32	2 7/8	6 3/8	150
160S40	S2	1 7/8 - 4 3/16	26.61	25.491	40	6	1.156	7 1/8	6 3/4	2 23/32	2 7/8	6 3/8	165
160S45	S2	1 7/8 - 4 3/16	29.80	28.671	45	6	1.156	7 1/8	6 3/4	2 23/32	2 7/8	6 3/8	204
160U60	U0	2 3/8 - 5 1/2	39.36	38.215	60	6	1.156	5 25/32	5 1/4	1 21/32	1 15/16	8 3/8	354
160U70	U0	2 3/8 - 5 1/2	45.73	44.578	70	6	1.156	5 25/32	5 1/4	1 21/32	1 15/16	8 3/8	308
160U80	U1	2 3/8 - 5 1/2	52.10	50.943	80	6	1.156	7 19/32	7 1/8	2 19/32	2 7/8	8 3/8	684

HARDENED TEETH

Standard Keyseats

Table No. 3

Bore Range	Keyseat
3/4" — 7/8"	3/16" X 3/32"
15/16 — 1 1/4	1/4 X 1/8
1 5/16 — 1 3/8	5/16 X 5/32
1 7/16 — 1 3/4	3/8 X 3/16
1 13/16 — 2 1/4	1/2 X 1/4
2 5/16 — 2 3/4	5/8 X 5/16
2 13/16 — 3 1/4	3/4 X 3/8
3 3/8 — 3 3/4	7/8 X 7/16
3 7/8 — 4 1/2	1 X 1/2
4 9/16 — 5 1/2	1 1/4 X 5/8

1 3/8" Bore Bushings also available with 3/8" x 3/16" Keyseat.

Where two sprockets with the same number of teeth but different bushings are offered, we suggest using the one with the larger bushing for heavier service drives.