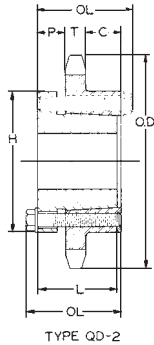

Table No. 1

Type "A" Steel Plate Sprockets



Part No.	Outside Dia.	Pitch Dia.	No. Teeth	Stock Bore	T (Nom.)	Wt. Lbs.	Part No.	Outside Dia.	Pitch Dia.	No. Teeth	Stock Bore	T (Nom.)	Wt. Lbs.
80A9	3.35"	2.924"	9	3/4"	.575"	1.0	80A40	13.31"	12.428"	40	1	.575"	20.0
80A10	3.68	3.236	10	3/4	.575	1.2	80A41	13.63	13.064	41	1	.575	20.7
80A11	4.01	3.550	11	3/4	.575	1.5	80A42	13.94	13.382	42	1	.575	21.3
80A12	4.33	3.864	12	3/4	.575	1.8	80A46	14.26	13.700	43	1	.575	23.0
80A13	4.66	4.179	13	3/4	.575	2.1	80A44	14.58	14.018	44	1	.575	23.9
80A14	4.98	4.494	14	3/4	.575	2.5	80A45	14.90	14.336	45	1	.575	25.7
80A15	5.30	4.810	15	3/4	.575	2.8	80A46	15.22	14.654	46	1	.575	26.3
80A16	5.63	5.126	16	3/4	.575	3.2	80A47	15.54	14.972	47	1	.575	27.5
80A17	5.95	5.442	17	3/4	.575	3.6	80A48	15.86	15.290	48	1	.575	28.8
80A18	6.27	5.759	18	3/4	.575	4.1	80A49	16.18	15.608	49	1	.575	31.3
80A19	6.59	6.076	19	3/4	.575	4.5	80A50	16.50	15.926	50	1	.575	32.4
80A20	6.91	6.392	20	3/4	.575	5.0	80A51	16.81	16.244	51	1	.575	33.9
80A21	7.24	6.710	21	3/4	.575	5.6	80A52	17.13	16.562	52	1	.575	36.1
80A22	7.56	7.027	22	3/4	.575	6.1	80A53	17.45	16.880	53	1	.575	34.9
80A23	7.88	7.344	23	3/4	.575	6.7	80A54	17.77	17.168	54	1	.575	35.6
80A24	8.20	7.661	24	3/4	.575	7.3	80A55	18.09	17.517	55	1	.575	38.1
80A25	8.52	7.979	25	3/4	.575	7.9	80A56	18.41	17.835	56	1	.575	39.9
80A26	8.84	8.296	26	1	.575	8.0	80A57	18.73	18.153	57	1	.575	40.6
80A27	9.16	8.614	27	1	.575	8.7	80A58	19.04	18.471	58	1	.575	41.8
80A28	9.48	8.931	28	1	.575	9.5	80A59	19.36	18.789	59	1	.575	43.0
80A29	9.80	9.249	29	1	.575	10.1	80A60	19.64	19.107	60	1	.575	43.6
80A30	10.11	9.567	30	1	.575	11.0	80A65	21.23	20.698	65	1	.575	53.4
80A31	10.43	9.885	31	1	.575	11.8	80A70	22.83	22.289	70	1	.575	62.0
80A32	10.75	10.202	32	1	.575	12.4	80A72	23.46	22.926	72	1	.575	63.0
80A33	11.07	10.520	33	1	.575	13.5	80A76	24.74	24.198	76	1 7/16	.575	71.4
80A34	11.39	10.838	34	1	.575	14.3	80A80	26.01	25.471	80	1 7/16	.575	77.0
80A35	11.71	11.156	35	1	.575	15.0	80A84	27.33	26.744	84	1 7/16	.575	86.0
80A36	11.98	11.474	36	1	.575	15.6	80A90	29.20	28.654	90	1 7/16	.575	97.0
80A37	12.35	11.792	37	1	.575	16.6	80A96	31.11	30.563	96	1 7/16	.575	119
80A38	12.67	12.110	38	1	.575	17.4	80A112	36.20	35.655	112	1 7/16	.575	153
80A39	12.99	12.428	39	1	.575	19.0							

Standard Keyseats

Table No. 3

Bore Range	Keyseat
1/2" — 9/16"	1/8" X 1/16"
5/8 — 7/8	3/16 X 3/32
15/16 — 1 1/4	1/4 X 1/8
1 5/16 — 1 3/8	5/16 X 5/32
1 7/16 — 1 3/4	3/8 X 3/16
1 13/16 — 2 1/4	1/2 X 1/4
2 5/16 — 2 3/4	5/8 X 5/16
2 13/16 — 3 1/4	3/4 X 3/8
3 3/8 — 3 3/4	7/8 X 7/16
3 7/8 — 4 1/2	1 X 1/2

1 3/8" Bore Bushings also available with 3/8" x 3/16" Keyseat.

Table No. 2

Steel Single Type "B" Minimum Bore Sprockets

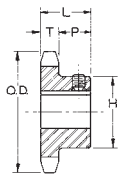

TYPE 1



TYPE A

Part No.	DIAMETERS		No. Teeth	Type	BORE		DIMENSIONS				Wt. Lbs.
	Outside	Pitch			Stock	Max.*	T Nom.	L Max.	P	H	
80B8	3.01"	2.613"	8	B	3/4"	1 1/16"	.575"	1 5/8	47/64"	1 61/64†	1.5
80B9	3.35	2.924	9	B	3/4	1 5/16	.575	1 5/8	47/64	2 17/64†	2.0
80B10	3.68	3.236	10	B	3/4	1 1/2	.575	1 5/8	47/64	2 37/64†	2.6
80B11	4.01	3.550	11	B	3/4	1 5/8	.575	1 5/8	47/64	2 57/64†	3.2
80B12	4.33	3.864	12	B	3/4	1 7/8	.575	1 5/8	47/64	3 13/64†	4.0
80B13	4.66	4.179	13	B	3/4	2 1/8	.575	1 1/2	47/64	3 5/32	3.5
80B14	4.98	4.494	14	B	3/4	2 1/4	.575	1 1/2	47/64	3 3/8	4.3
80B15	5.31	4.810	15	B	3/4	2 1/2	.575	1 1/2	47/64	3 13/16	5.2
80B16	5.63	5.126	16	B	3/4	2 5/8	.575	1 1/2	47/64	3 7/8	5.6
80B17	5.95	5.442	17	B	3/4	2 5/8	.575	1 1/2	47/64	4 1/4	6.0
80B18	6.27	5.759	18	B	3/4	2 3/4	.575	1 1/2	47/64	4 1/4	7.0
80B19	6.59	6.076	19	B	3/4	2 3/4	.575	1 5/8	47/64	4 1/4	7.5
80B20	6.91	6.392	20	B	3/4	2 3/4	.575	1 5/8	47/64	4 1/4	8.0
80B21	7.24	6.710	21	B	3/4	2 3/4	.575	1 5/8	1 3/64	4 1/4	9.8
80B22	7.56	7.027	22	B	3/4	2 3/4	.575	1 5/8	1 3/64	4 1/4	10.3

*Maximum bore shown is with standard keyway and setscrew over keyway. Slightly larger bores are possible with no keyway, shallow keyway or setscrew at angle to keyway.

†Hub is recessed for chain clearance

These Type "B" and "C" Sprockets are furnished with no keyway and no setscrew. They are made with minimum bore which can be rebored to size, keywayed and setscrewed for a reasonable extra charge.