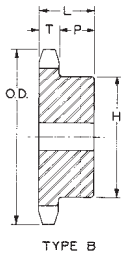
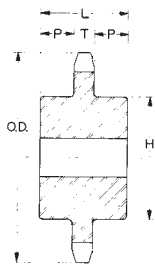

Table No. 1 **Steel Single Minimum Bore Sprockets**



TYPE B



TYPE C

Part No.	DIAMETERS		No. Teeth	Type	BORE		DIMENSIONS				Wt. Lbs.
	Outside	Pitch			Stock	Max. *	T Nom.	L Max.	P	H	
120B9	5.02"	4.386"	9	B	1	1 3/4"	.924"	2 1/4"	1 21/64"	3 31/64"	7.1
120B10	5.52	4.854	10	B	1	2 1/4"	.924	2 1/4"	1 21/64"	3 61/64"	9.0
120B11	6.01	5.324	11	B	1	2 3/8"	.924	2	1 5/64"	3 9/16"	11.4
120B12	6.50	5.796	12	B	1	2 3/4"	.924	2	1 5/64"	4 1/8"	10.8
120B13	6.99	6.268	13	B	1	3	.924	2 1/4"	1 21/64"	4 9/16"	14.2
120B14	7.47	6.741	14	B	1	3 1/4"	.924	2 1/4"	1 21/64"	4 3/4"	15.5
120B15	7.96	7.215	15	B	1	3 1/4"	.924	2 1/4"	1 21/64"	4 3/4"	16.8
120B16	8.39	7.689	16	B	1	3 1/2"	.924	2 1/4"	1 21/64"	5 1/4"	19.8
120B17	8.88	8.163	17	B	1	3 1/2"	.924	2 1/4"	1 21/64"	5 1/4"	21.3
120B18	9.41	8.638	18	B	1	3 1/2"	.924	2 1/4"	1 21/64"	5 1/4"	22.9
120B19	9.89	9.113	19	B	1	3 1/2"	.924	2 1/4"	1 21/64"	5 1/4"	24.7
120B20	10.37	9.589	20	B	1	3 1/2"	.924	2 1/4"	1 21/64"	5 1/4"	26.5
120B21	10.85	10.064	21	B	1	3 1/2"	.924	2 1/4"	1 21/64"	5 1/4"	28.4
120B22	11.33	10.540	22	B	1	3 1/2"	.924	2 1/4"	1 21/64"	5 1/4"	30.4
120B23	11.81	11.016	23	B	1	3 1/2"	.924	2 1/4"	1 21/64"	5 1/4"	32.5
120B24	12.29	11.492	24	B	1	3 1/2"	.924	2 1/4"	1 21/64"	5 1/4"	34.7
120B25	12.77	11.968	25	B	1	3 1/2"	.924	2 1/4"	1 21/64"	5 1/4"	37.0
120B26	13.25	12.444	26	B	1	4	.924	2 7/16"	1 33/64"	6	43.4
120B28	14.21	13.397	28	B	1	4	.924	2 7/16"	1 33/64"	6	48.4
120B30	15.17	14.350	30	B	1	4	.924	2 7/16"	1 33/64"	6	53.9
120B32	16.13	15.303	32	B	1	4	.924	2 7/16"	1 33/64"	6	59.7
120B35	17.57	16.734	35	B	1	4	.924	2 7/16"	1 33/64"	6	69.1
120B36	18.05	17.211	36	B	1	4	.924	2 7/16"	1 33/64"	6	72.4
120C40	19.96	19.118	40	C	1 7/16	4 1/2"	.924	3	1 1/32"	6 5/8"	93.9
120C42	20.92	20.072	42	C	1 7/16	4 1/2"	.924	3	1 1/32"	6 5/8"	102
120C45	22.35	21.503	45	C	1 7/16	4 1/2"	.924	3 1/16"	1 1/16"	6 5/8"	114
120C48	23.79	22.935	48	C	1 1/2	4 1/2"	.924	3 1/16"	1 1/16"	6 5/8"	127
120C54	26.65	25.798	54	C	1 1/2	4 1/2"	.924	3 1/16"	1 1/16"	6 5/8"	156
120C60	29.52	28.661	60	C	1 1/2	5 3/8"	.924	3 1/16"	1 1/16"	7 5/8"	195
120C70	34.30	33.434	70	C	1 1/2	5 3/8"	.924	3 1/16"	1 1/16"	7 5/8"	256
120C80	39.08	38.207	80	C	1 1/2	5 3/8"	.924	3 1/16"	1 1/16"	7 5/8"	326

* Maximum bores shown will accommodate standard keyway and setscrew over keyway. Slightly larger bores are possible with no keyway, shallow keyway or setscrew at angle to keyway.

† Hub is recessed for chain clearance

These sprockets are furnished with minimum bore and no keyway. They can be rebored to size, keywayed and setscrewed for a reasonable extra charge.

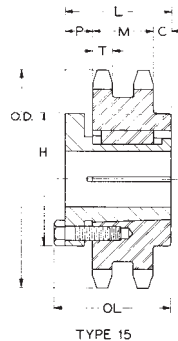

TYPE 15

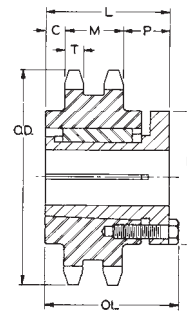

TYPE 18

Table No. 2 **Steel Double Sprockets with Browning Split Taper® Bushings**

Part No.	Bushing	Bore Range	DIAMETERS		Type	No. Teeth	DIMENSIONS						Wt. Less Bushing	
			Outside	Pitch			T	M	OL	L	P	C		H
D120S30	S1	1 11/16 - 4 1/4"	15.17"	14.350"	15	30	.894"	2.683"	4 3/4"	4 3/8"	1 1/16"	5/8"	6 3/8"	105
D120S35	S1	1 11/16 - 4 1/4"	17.57	16.734	15	35	.894	2.683	4 3/4"	4 3/4"	1 1/16"	5/8"	6 3/8"	148
D120S45	S2	1 7/8 - 4 3/16	22.35	21.503	18	45	.894	2.683	7 1/8"	6 3/4"	2 7/32"	1 27/32"	6 3/8"	268
D120U60	U0	2 3/8 - 5 1/2"	29.52	28.661	15	60	.894	2.683	5 23/32"	5 1/4"	1 9/32"	1 9/32"	8 3/8"	183

Table No. 3 **Steel Double Sprockets with Q-D® Bushings**

Part No.	Bushing	Bore Range	DIMENSIONS		Type	No. Teeth	DIMENSIONS						Wt. Less Bushing	
			Outside	Pitch			T	M	OL	L	P	C		H
D120J30	J	1 1/2 - 4 1/2"	15.17"	14.350"	QD-4	30	.894"	2.683"	5 5/16"	4 5/8"	1 13/32"	21/32"	7 1/4"	103
D120J35	J	1 1/2 - 4 1/2"	17.57	16.734	QD-4	35	.894	2.683	5 5/16"	4 5/8"	1 13/32"	21/32"	7 1/4"	145
D120J45	J	1 1/2 - 4 1/2"	22.35	21.502	QD-4	45	.894	2.683	5 5/16"	4 5/8"	1 13/32"	21/32"	7 1/4"	251

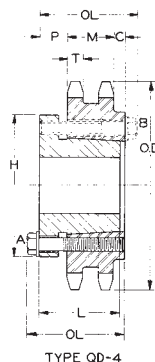

TYPE QD-4