

Sprockets for No. 100, 1 1/4" Pitch ANSI Chain

Table No. 1 Steel Single Sprockets with Q-D® Bushings

| Part No. | Bushing | Bore Range | DIAMETERS | | Type | No. Teeth | DIMENSIONS | | | | | | Wt. Less Bushing |
|-----------|---------|---------------|-----------|--------|------|-----------|------------|----------|---------|--------|---------|--------|------------------|
| | | | Outside | Pitch | | | T Nom. | OL | L | P | C | H | |
| | | | | | | | | | | | | | |
| H100SDS11 | SDS | 1/2 - 2" | 5.01" | 4.437" | QD-1 | 11 | .692" | 1 21/32" | 1 5/16" | 3/4" | - | 3 1/8" | 2.33 |
| H100SDS12 | SDS | 1/2 - 2 | 5.42 | 4.830 | QD-1 | 12 | .692 | 1 21/32 | 1 5/16 | 3/4 | - | 3 1/8 | 2.91 |
| H100SK13 | SK | 1/2 - 2 5/8 | 5.82 | 5.223 | QD-1 | 13 | .692 | 2 11/32 | 1 15/16 | 1 3/8 | - | 3 7/8 | 3.80 |
| H100SK14 | SK | 1/2 - 2 5/8 | 6.23 | 5.617 | QD-1 | 14 | .692 | 2 11/32 | 1 15/16 | 1 3/8 | - | 3 7/8 | 4.62 |
| H100SF15 | SF | 1/2 - 2 15/16 | 6.63 | 6.012 | QD-1 | 15 | .692 | 2 15/32 | 2 1/16 | 1 7/16 | - | 4 5/8 | 5.5 |
| H100SF16 | SF | 1/2 - 2 15/16 | 7.03 | 6.407 | QD-1 | 16 | .692 | 2 15/32 | 2 1/16 | 1 7/16 | - | 4 5/8 | 6.2 |
| H100SF17 | SF | 1/2 - 2 15/16 | 7.44 | 6.803 | QD-1 | 17 | .692 | 2 15/32 | 2 1/16 | 1 7/16 | - | 4 5/8 | 7.0 |
| H100E18 | E | 7/8 - 3 1/2 | 7.84 | 7.198 | QD-1 | 18 | .692 | 3 1/4 | 2 3/4 | 2 1/8 | - | 6 | 9.9 |
| H100E19 | E | 7/8 - 3 1/2 | 8.24 | 7.595 | QD-1 | 19 | .692 | 3 1/4 | 2 3/4 | 2 1/8 | - | 6 | 11.0 |
| H100E20 | E | 7/8 - 3 1/2 | 8.64 | 7.991 | QD-1 | 20 | .692 | 3 1/4 | 2 3/4 | 2 1/8 | - | 6 | 11.7 |
| H100E21 | E | 7/8 - 3 1/2 | 9.04 | 8.387 | QD-1 | 21 | .692 | 3 1/4 | 2 3/4 | 2 1/8 | - | 6 | 12.6 |
| H100E22 | E | 7/8 - 3 1/2 | 9.44 | 8.783 | QD-1 | 22 | .692 | 3 1/4 | 2 3/4 | 2 1/8 | - | 6 | 13.6 |
| H100E23 | E | 7/8 - 3 1/2 | 9.84 | 9.180 | QD-1 | 23 | .692 | 3 1/4 | 2 3/4 | 2 1/8 | - | 6 | 14.6 |
| H100E24 | E | 7/8 - 3 1/2 | 10.25 | 9.557 | QD-1 | 24 | .692 | 3 1/4 | 2 3/4 | 2 1/8 | - | 6 | 15.6 |
| H100E25 | E | 7/8 - 3 1/2 | 10.65 | 9.973 | QD-1 | 25 | .692 | 3 1/4 | 2 3/4 | 2 1/8 | - | 6 | 16.7 |
| H100E26 | E | 7/8 - 3 1/2 | 11.05 | 10.370 | QD-1 | 26 | .692 | 3 1/4 | 2 3/4 | 2 1/8 | - | 6 | 17.8 |
| H100E27 | E | 7/8 - 3 1/2 | 11.44 | 10.767 | QD-1 | 27 | .692 | 3 1/4 | 2 3/4 | 2 1/8 | - | 6 | 19.0 |
| H100E28 | E | 7/8 - 3 1/2 | 11.84 | 11.164 | QD-1 | 28 | .692 | 3 1/4 | 2 3/4 | 2 1/8 | - | 6 | 20.2 |
| H100E30 | E | 7/8 - 3 1/2 | 12.64 | 11.958 | QD-1 | 30 | .692 | 3 1/4 | 2 3/4 | 2 1/8 | - | 6 | 22.8 |
| 100E32 | E | 7/8 - 3 1/2 | 13.44 | 12.753 | QD-1 | 32 | .692 | 3 1/4 | 2 3/4 | 2 1/8 | - | 6 | 25.5 |
| 100E35 | E | 7/8 - 3 1/2 | 14.64 | 13.945 | QD-1 | 35 | .692 | 3 1/4 | 2 3/4 | 2 1/8 | - | 6 | 29.9 |
| 100E36 | E | 7/8 - 3 1/2 | 15.04 | 14.342 | QD-1 | 36 | .692 | 3 1/4 | 2 3/4 | 2 1/8 | - | 6 | 31.5 |
| 100E40 | E | 7/8 - 3 1/2 | 16.63 | 15.932 | QD-1 | 40 | .692 | 3 1/4 | 2 3/4 | 2 1/8 | - | 6 | 38.2 |
| 100E42 | E | 7/8 - 3 1/2 | 17.43 | 16.727 | QD-1 | 42 | .692 | 3 1/4 | 2 3/4 | 2 1/8 | - | 6 | 41.8 |
| 100E45 | E | 7/8 - 3 1/2 | 18.63 | 17.920 | QD-1 | 45 | .692 | 3 1/4 | 2 3/4 | 2 1/8 | - | 6 | 47.5 |
| 100E48 | E | 7/8 - 3 1/2 | 19.82 | 19.112 | QD-1 | 48 | .692 | 3 1/4 | 2 3/4 | 2 1/8 | - | 6 | 53.7 |
| 100E54 | E | 7/8 - 3 1/2 | 22.21 | 21.498 | QD-2 | 54 | .692 | 3 1/4 | 2 3/4 | 1 3/16 | 1 25/64 | 6 | 67.1 |
| 100E60 | E | 7/8 - 3 1/2 | 24.60 | 23.884 | QD-2 | 60 | .692 | 3 1/4 | 2 3/4 | 1 3/16 | 1 25/64 | 6 | 82.2 |
| 100F70 | F | 1 - 4 | 28.58 | 27.862 | QD-2 | 70 | .692 | 4 3/8 | 3 3/4 | 1 3/8 | 2 21/64 | 6 5/8 | 117 |
| 100F72 | F | 1 - 4 | 29.38 | 28.657 | QD-2 | 72 | .692 | 4 3/8 | 3 3/4 | 1 3/8 | 2 21/64 | 6 5/8 | 123 |
| 100F80 | F | 1 - 4 | 32.57 | 31.839 | QD-2 | 80 | .692 | 4 3/8 | 3 3/4 | 1 3/8 | 2 21/64 | 6 5/8 | 140 |
| 100F84 | F | 1 - 4 | 34.16 | 33.430 | QD-2 | 84 | .692 | 4 3/8 | 3 3/4 | 1 3/8 | 2 21/64 | 6 5/8 | 154 |

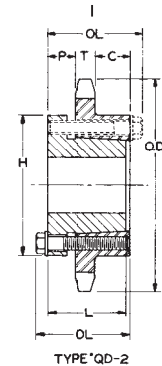
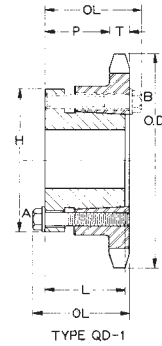

HARDENED TEETH

Table No. 2 Type "A" Steel Plate Sprockets

| Part No. | Outside Dia. | Pitch Dia. | No. Teeth | Stock Bore | T (Nom.) | Wt. Lbs. | Part No. | Outside Dia. | Pitch Dia. | No. Teeth | Stock Bore | T (Nom.) | Wt. Lbs. |
|----------|--------------|------------|-----------|------------|----------|----------|----------|--------------|------------|-----------|------------|----------|----------|
| 100A7 | 3.35" | 2.881" | 7 | 1" | .692" | .9 | 100A38 | 15.84" | 15.137" | 38 | 1" | .692" | 31.7 |
| 100A8 | 3.77 | 3.266 | 8 | 1 | .692 | 1.0 | 100A39 | 16.23 | 15.534 | 39 | 1 | .692 | 33.4 |
| 100A9 | 4.18 | 3.665 | 9 | 1 | .692 | 1.5 | 100A40 | 16.63 | 15.932 | 40 | 1 | .692 | 35.1 |
| 100A10 | 4.60 | 4.045 | 10 | 1 | .692 | 2.0 | 100A41 | 17.03 | 16.329 | 41 | 1 | .692 | 36.9 |
| 100A11 | 5.01 | 4.437 | 11 | 1 | .692 | 2.3 | 100A42 | 17.43 | 16.727 | 42 | 1 | .692 | 38.7 |
| 100A12 | 5.42 | 4.830 | 12 | 1 | .692 | 3.1 | 100A43 | 17.83 | 17.124 | 43 | 1 | .692 | 40.6 |
| 100A13 | 5.82 | 5.223 | 13 | 1 | .692 | 3.4 | 100A44 | 18.23 | 17.522 | 44 | 1 | .692 | 42.5 |
| 100A14 | 6.23 | 5.617 | 14 | 1 | .692 | 4.1 | 100A45 | 18.63 | 17.920 | 45 | 1 | .692 | 44.5 |
| 100A15 | 6.63 | 6.012 | 15 | 1 | .692 | 4.8 | 100A46 | 19.02 | 18.317 | 46 | 1 | .692 | 46.5 |
| 100A16 | 7.03 | 6.407 | 16 | 1 | .692 | 5.4 | 100A47 | 19.42 | 18.715 | 47 | 1 | .692 | 48.5 |
| 100A17 | 7.44 | 6.803 | 17 | 1 | .692 | 6.2 | 100A48 | 19.82 | 19.112 | 48 | 1 | .692 | 50.6 |
| 100A18 | 7.84 | 7.198 | 18 | 1 | .692 | 7.2 | 100A49 | 20.22 | 19.510 | 49 | 1 | .692 | 52.7 |
| 100A19 | 8.24 | 7.595 | 19 | 1 | .692 | 7.5 | 100A50 | 20.62 | 19.908 | 50 | 1 | .692 | 54.9 |
| 100A20 | 8.64 | 7.991 | 20 | 1 | .692 | 8.9 | 100A51 | 21.02 | 20.305 | 51 | 1 | .692 | 57.1 |
| 100A21 | 9.04 | 8.387 | 21 | 1 | .692 | 9.6 | 100A52 | 21.42 | 20.703 | 52 | 1 | .692 | 59.4 |
| 100A22 | 9.44 | 8.783 | 22 | 1 | .692 | 11.3 | 100A53 | 21.81 | 21.100 | 53 | 1 | .692 | 61.7 |
| 100A23 | 9.84 | 9.180 | 23 | 1 | .692 | 12.0 | 100A54 | 22.21 | 21.498 | 54 | 1 | .692 | 64.1 |
| 100A24 | 10.25 | 9.577 | 24 | 1 | .692 | 13.3 | 100A55 | 22.61 | 21.896 | 55 | 1 | .692 | 66.5 |
| 100A25 | 10.65 | 9.973 | 25 | 1 | .692 | 14.1 | 100A56 | 23.01 | 22.296 | 56 | 1 | .692 | 68.9 |
| 100A26 | 11.05 | 10.370 | 26 | 1 | .692 | 15.3 | 100A57 | 23.41 | 22.691 | 57 | 1 | .692 | 71.4 |
| 100A27 | 11.44 | 10.767 | 27 | 1 | .692 | 16.4 | 100A58 | 23.81 | 23.089 | 58 | 1 | .692 | 73.9 |
| 100A28 | 11.84 | 11.164 | 28 | 1 | .692 | 17.5 | 100A59 | 24.20 | 23.486 | 59 | 1 | .692 | 76.5 |
| 100A29 | 12.24 | 11.561 | 29 | 1 | .692 | 19.6 | 100A60 | 24.60 | 23.884 | 60 | 1 | .692 | 79.1 |
| 100A30 | 12.64 | 11.958 | 30 | 1 | .692 | 20.4 | 100A70 | 28.58 | 27.862 | 70 | 1 7/16 | .692 | 108 |
| 100A31 | 13.04 | 12.356 | 31 | 1 | .692 | 22.3 | 100A72 | 29.38 | 28.657 | 72 | 1 7/16 | .692 | 114 |
| 100A32 | 13.44 | 12.753 | 32 | 1 | .692 | 22.5 | 100A76 | 30.97 | 30.248 | 76 | 1 7/16 | .692 | 127 |
| 100A33 | 13.84 | 13.150 | 33 | 1 | .692 | 23.9 | 100A80 | 32.96 | 32.237 | 80 | 1 7/16 | .692 | 141 |
| 100A34 | 14.24 | 13.547 | 34 | 1 | .692 | 25.4 | 100A84 | 34.16 | 33.430 | 84 | 1 7/16 | .692 | 155 |
| 100A35 | 14.64 | 13.945 | 35 | 1 | .692 | 26.9 | 100A90 | 36.55 | 35.817 | 90 | 1 7/16 | .692 | 178 |
| 100A36 | 15.04 | 14.342 | 36 | 1 | .692 | 28.4 | 100A96 | 38.93 | 38.203 | 96 | 1 7/16 | .692 | 202 |
| 100A37 | 15.44 | 14.740 | 37 | 1 | .692 | 30.0 | | | | | | | |

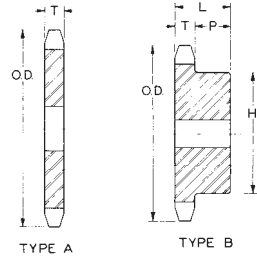

Standard Keyseats

Table No. 3

| Bore Range | Keyseat |
|-----------------|--------------|
| 1/2" — 9/16" | 1/8" X 1/16" |
| 5/8 — 7/8 | 3/16 X 3/32 |
| 15/16 — 1 1/4 | 1/4 X 1/8 |
| 1 5/16 — 1 3/8 | 5/16 X 5/32 |
| 1 7/16 — 1 3/4 | 3/8 X 3/16 |
| 1 13/16 — 2 1/4 | 1/2 X 1/4 |
| 2 5/16 — 2 3/4 | 5/8 X 5/16 |
| 2 13/16 — 3 1/4 | 3/4 X 3/8 |
| 3 3/8 — 3 3/4 | 7/8 X 7/16 |
| 3 7/8 — 4 1/2 | 1 X 1/2 |

1 3/8" Bore Bushings also available with 3/8" x 3/16" Keyseat.