

ARMSTRONG® 3/8" Drive 6 and 12 Point SAE Deep Length Sockets

- Made in the USA - Quality and Availability
- Radius Corner Design Engages the Flats of the Fastener, Not the Corners, Providing Up to 15% -20% More Torque While Reducing Fastener Rounding, Enhancing the Turning of Worn Fasteners
- EYE-D™ Markings Optimize Size Visibility, Also Providing SAE / Metric Differentiation
- Unique Socket Retention Method, Cold Form Ball Recess, Provides Consistent Secure Retention of the Socket to the Drive Tool Eliminating the Possibility of Either a Loose Fit or Tight Fit
- Socket Wall Dimensions are Optimized to Provide Strength While Retaining Access to Restricted Fasteners
- Meets or Exceeds ASME B107.1-2002 and US Federal Spec. GGG-W-641 E

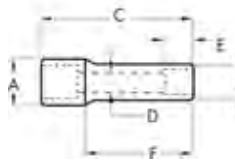

Cat. No.	UPC No.	Packaging	Drive Type	Fastener Size	Dim. A: Drive End	Dim. B: Wrench End	Dim. C: Overall Length	Dim. D: Bolt Clearance	Dim. E: Wrench Depth	Dim. F: Length to Shoulder	Product Weight	Shelf Pack Qty.
11-208D	781412112085	Bagged	6 Point	1/4 in	0.648 in	0.410 in	2.500 in	0.310 in	0.440 in	0.865 in	0.07 lb	1
11-210D	781412112108	Bagged	6 Point	5/16 in	0.648 in	0.490 in	2.500 in	0.310 in	0.440 in	0.865 in	0.09 lb	1
11-211	781412112115	Bagged	6 Point	11/32 in	0.648 in	0.500 in	2.500 in	0.310 in	0.440 in	0.865 in	0.11 lb	1
11-212	781412112122	Bagged	6 Point	3/8 in	0.648 in	0.561 in	2.500 in	0.310 in	0.375 in	0.865 in	0.12 lb	1
11-214D	781412112146	Bagged	6 Point	7/16 in	0.651 in	0.651 in	2.500 in	0.370 in	0.680 in	-	0.12 lb	1
11-216	781412112160	Bagged	6 Point	1/2 in	0.724 in	0.724 in	2.500 in	0.470 in	1.188 in	-	0.15 lb	1
11-218	781412112184	Bagged	6 Point	9/16 in	0.774 in	0.774 in	2.500 in	0.505 in	1.378 in	-	0.16 lb	1
11-220	781412112207	Bagged	6 Point	5/8 in	0.860 in	0.860 in	2.500 in	0.615 in	1.377 in	-	0.20 lb	1
11-222D	781412112221	Bagged	6 Point	11/16 in	0.950 in	0.950 in	2.500 in	0.660 in	1.377 in	-	0.24 lb	1
11-224	781412112245	Bagged	6 Point	3/4 in	1.001 in	1.001 in	2.500 in	0.740 in	1.377 in	-	0.26 lb	1
11-226	781412112269	Bagged	6 Point	13/16 in	1.107 in	1.107 in	2.500 in	0.770 in	1.500 in	-	0.35 lb	1
11-228	781412112283	Bagged	6 Point	7/8 in	1.169 in	1.169 in	2.513 in	0.884 in	1.500 in	-	0.37 lb	1
11-230	781412112306	Bagged	6 Point	15/16 in	1.250 in	1.250 in	2.520 in	0.870 in	1.300 in	-	0.46 lb	1
11-232	781412112320	Bagged	6 Point	1 in	1.310 in	1.310 in	2.520 in	0.870 in	1.300 in	-	0.47 lb	1
11-308	781412113082	Bagged	12 Point	1/4 in	0.648 in	0.410 in	2.500 in	0.310 in	0.440 in	0.865 in	0.07 lb	1
11-310	781412113105	Bagged	12 Point	5/16 in	0.648 in	0.490 in	2.500 in	0.310 in	0.440 in	0.865 in	0.08 lb	1
11-311	781412113112	Bagged	12 Point	11/32 in	0.648 in	0.500 in	2.500 in	0.310 in	0.440 in	0.865 in	0.08 lb	1
11-312	781412113129	Bagged	12 Point	3/8 in	0.649 in	0.561 in	2.500 in	0.380 in	0.375 in	0.865 in	0.09 lb	1
11-314	781412113143	Bagged	12 Point	7/16 in	0.653 in	0.653 in	2.500 in	0.344 in	0.870 in	-	0.09 lb	1
11-316	781412113167	Bagged	12 Point	1/2 in	0.724 in	0.724 in	2.500 in	0.460 in	1.188 in	-	0.13 lb	1
11-318	781412113181	Bagged	12 Point	9/16 in	0.773 in	0.773 in	2.500 in	0.570 in	1.377 in	-	0.15 lb	1
11-320	781412113204	Bagged	12 Point	5/8 in	0.860 in	0.860 in	2.500 in	0.615 in	1.377 in	-	0.18 lb	1
11-322	781412113228	Bagged	12 Point	11/16 in	0.950 in	0.950 in	2.500 in	0.660 in	1.377 in	-	0.23 lb	1
11-324	781412113242	Bagged	12 Point	3/4 in	1.000 in	1.000 in	2.500 in	0.740 in	1.377 in	-	0.27 lb	1
11-326D	781412113266	Bagged	12 Point	13/16 in	1.108 in	1.108 in	2.500 in	0.765 in	1.500 in	-	0.27 lb	1
11-328	781412113280	Bagged	12 Point	7/8 in	1.170 in	1.170 in	2.513 in	0.815 in	1.500 in	-	0.32 lb	1
11-330	781412113303	Bagged	12 Point	15/16 in	1.250 in	1.250 in	2.520 in	0.870 in	1.300 in	-	0.37 lb	1
11-332	781412113327	Bagged	12 Point	1 in	1.310 in	1.310 in	2.520 in	0.870 in	1.300 in	-	0.47 lb	1